

## List of Maps (from Table of Contents)

---

30. Lea Marston_Green Belt Infill Boundary_ Site Proposals 2021	2
31. Middleton_Green Belt Infill Boundary_2021	3
32. Strategic Gap 2021	4
33. Kingsbury Water Park_Site Proposals 2021	5
34. Atherstone Town Centre Boundary 2021	6
35. Polesworth Town Centre Boundary 2021	7
36. Coleshill town centre boundary 2021	8
37. Neighbourhood Centres Landscape 2021	9
38. Safeguarded Station Site Arley 2021	10
39. Safeguarded station Site Kingsbury 2021	11
40. & 41. Policy LP24 Additional Station parking areas of search	12
1 - Atherstone Station-Additional Parking Areas of Search	12
2 - Coleshill Station - Additional Parking - Areas of Search	13
42. Safeguarded_Route_Former_Baxterley_to_Birch_Coppice_Site Proposals 2021	14
43. Safeguarded Route - Former Hampton in Arden to Whitacre Rail Route 2021	15
44. HS2 Phase 1 and 2b 2021	16

Policy LP3 - Lea Marston - Green Belt Infill Boundary

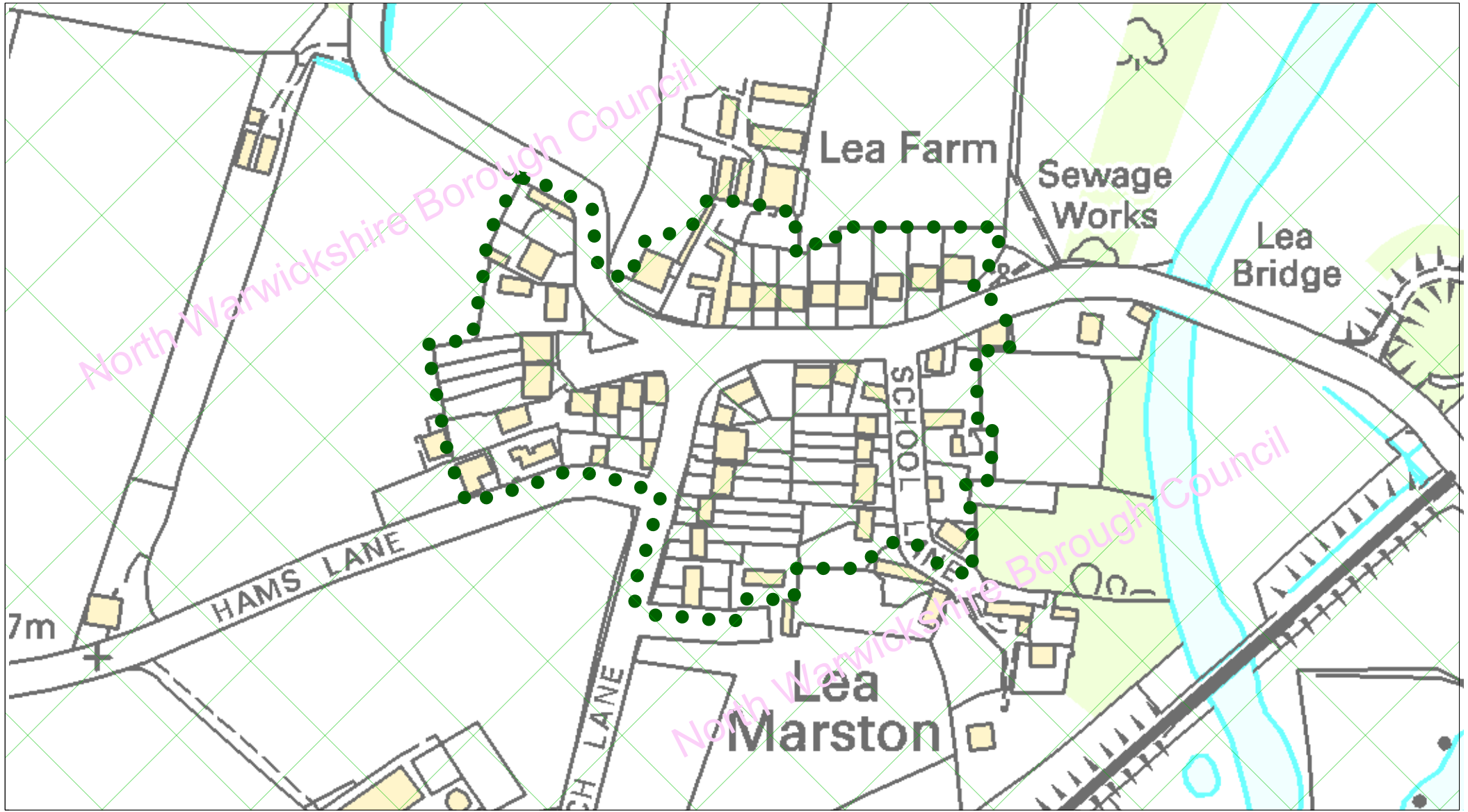

North Warwickshire Local Plan  
 Adopted September 2021  
 Lea Marston - Green Belt Infill Boundary

(C) Crown copyright and database rights 2021  
 Ordnance Survey 100017910

Green Belt shown hatched.  
 Green Belt Infill boundary shown dotted green

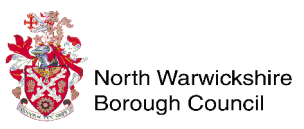

# Policy LP3 - Middleton - Green Belt Infill Boundary

## Middleton



North Warwickshire Local Plan  
 Adopted September 2021  
 Middleton - Green Belt Infill Boundary

(C) Crown copyright and database rights 2021  
 Ordnance Survey 100017910

Green Belt shown hatched.  
 Green Belt Infill boundary shown dotted green.



# Policy LP4 - Strategic Gap

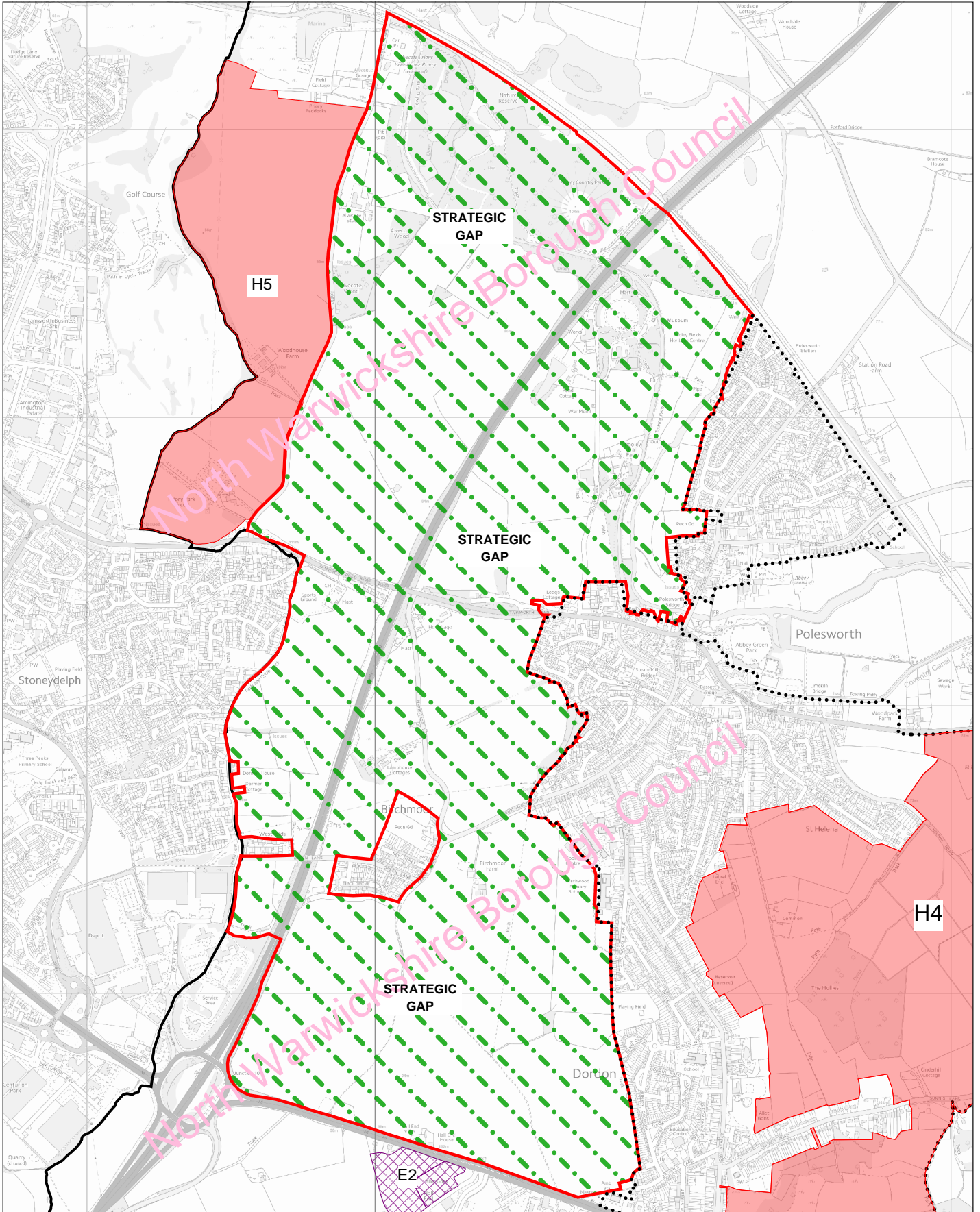

Date: 02:09:21  
Scale: 1:18000

North Warwickshire Local Plan  
Adopted September 2021  
Strategic Gap

© Crown copyright and database rights 2021  
Ordnance Survey 100017910



North Warwickshire  
Borough Council



Strategic Gap  
- shown green dash-dot



# Policy LP18 - Tame Valley Wetlands NIA including Kingsbury Water Park

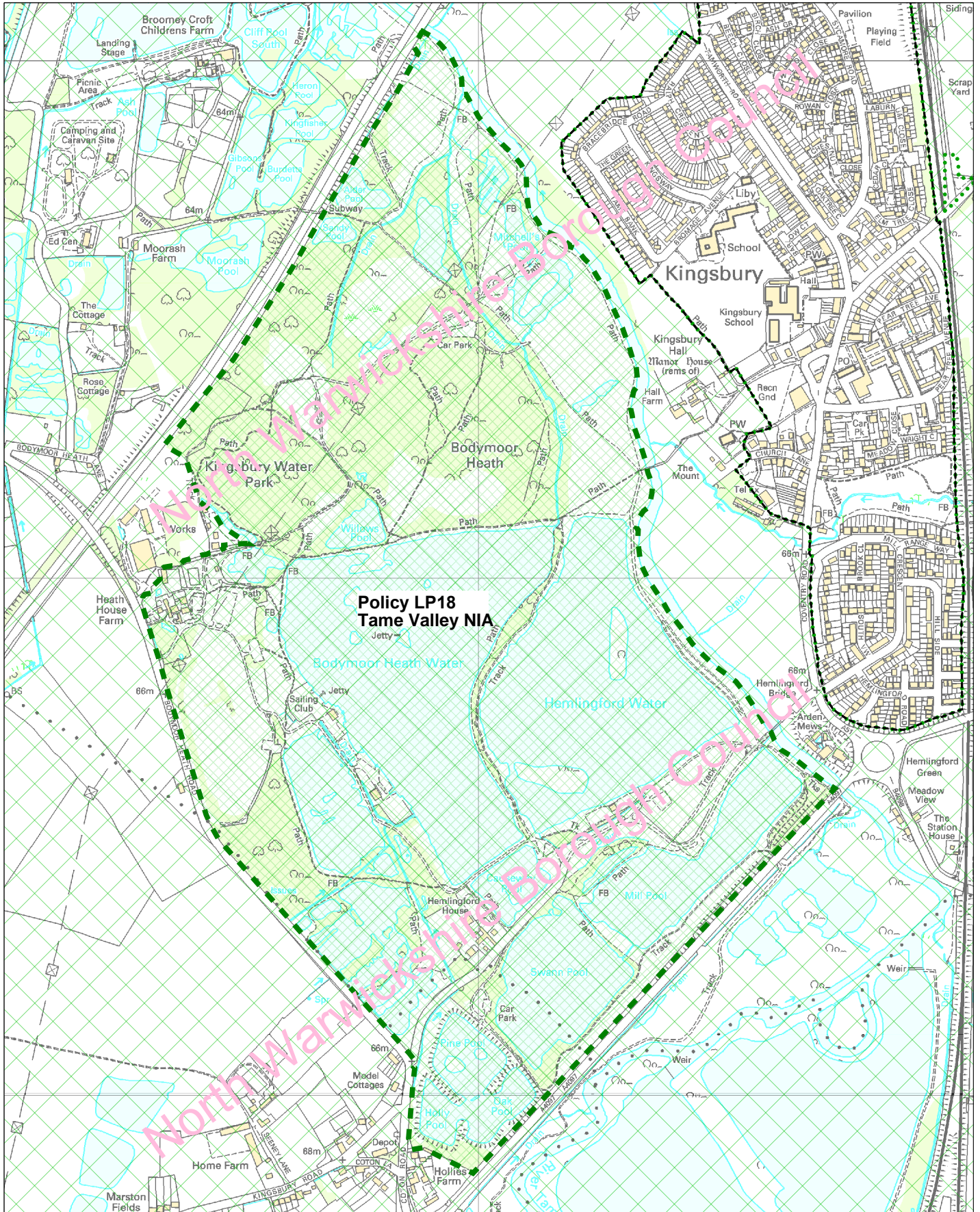

North Warwickshire Local Plan  
 Adopted September 2021  
 Tame Valley Wetlands NIA including Kingsbury Water Park

© Crown copyright and database rights  
 2021 Ordnance Survey 100017910



Area outlined in green  
 dash subject to Plan  
 Policy LP18



# Policy LP21 - Atherstone Town Centre Boundary

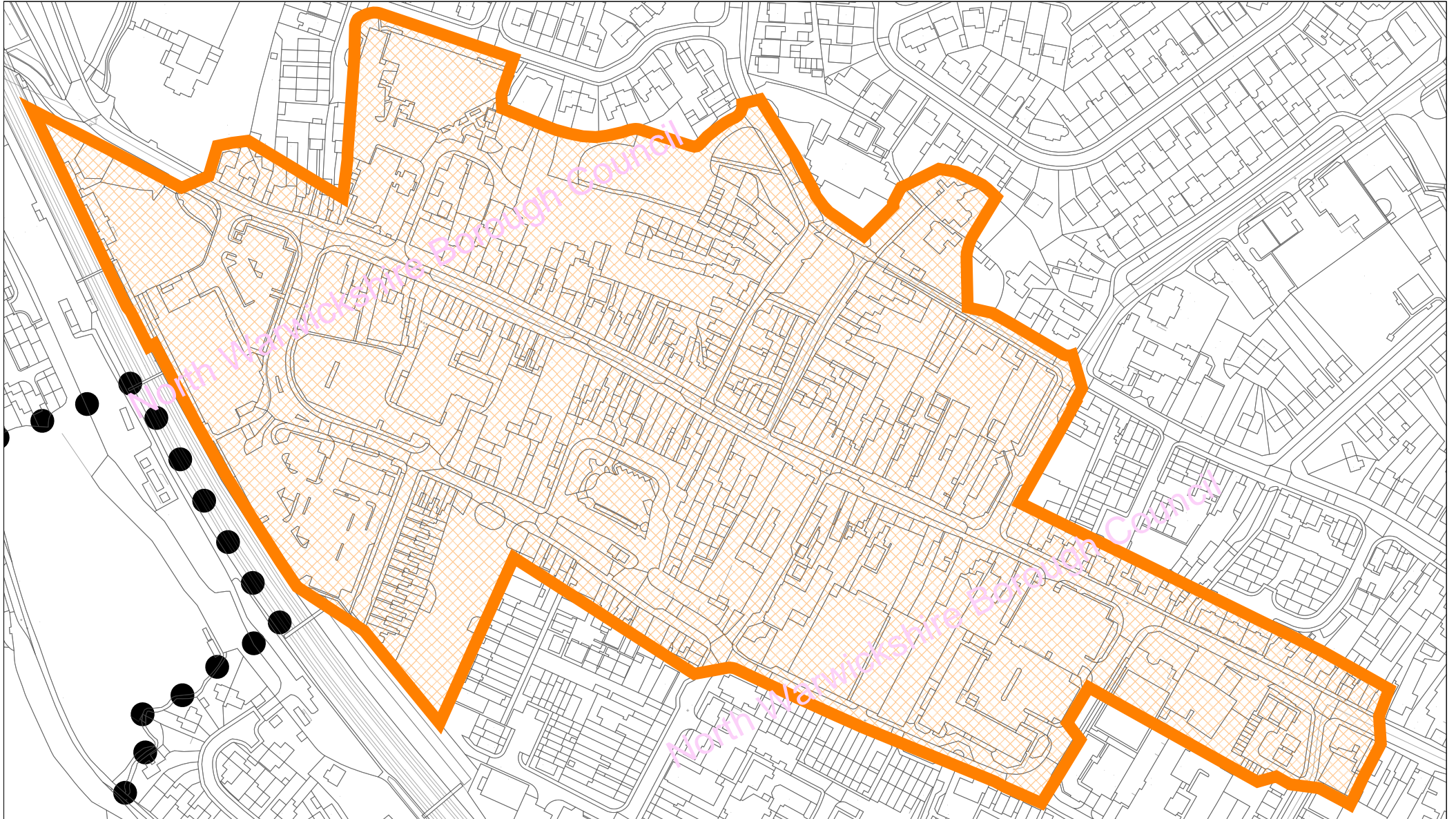

Date: 03:09:21  
 Scale: 1:2750  
**North Warwickshire Local Plan**  
**Adopted September 2021**  
**Atherstone Town Centre Boundary**

(C) Crown copyright and database rights 2021 Ordnance Survey 100017910



North Warwickshire  
 Borough Council



Town Centre Boundary



# Policy LP21 - Polesworth Town Centre Boundary

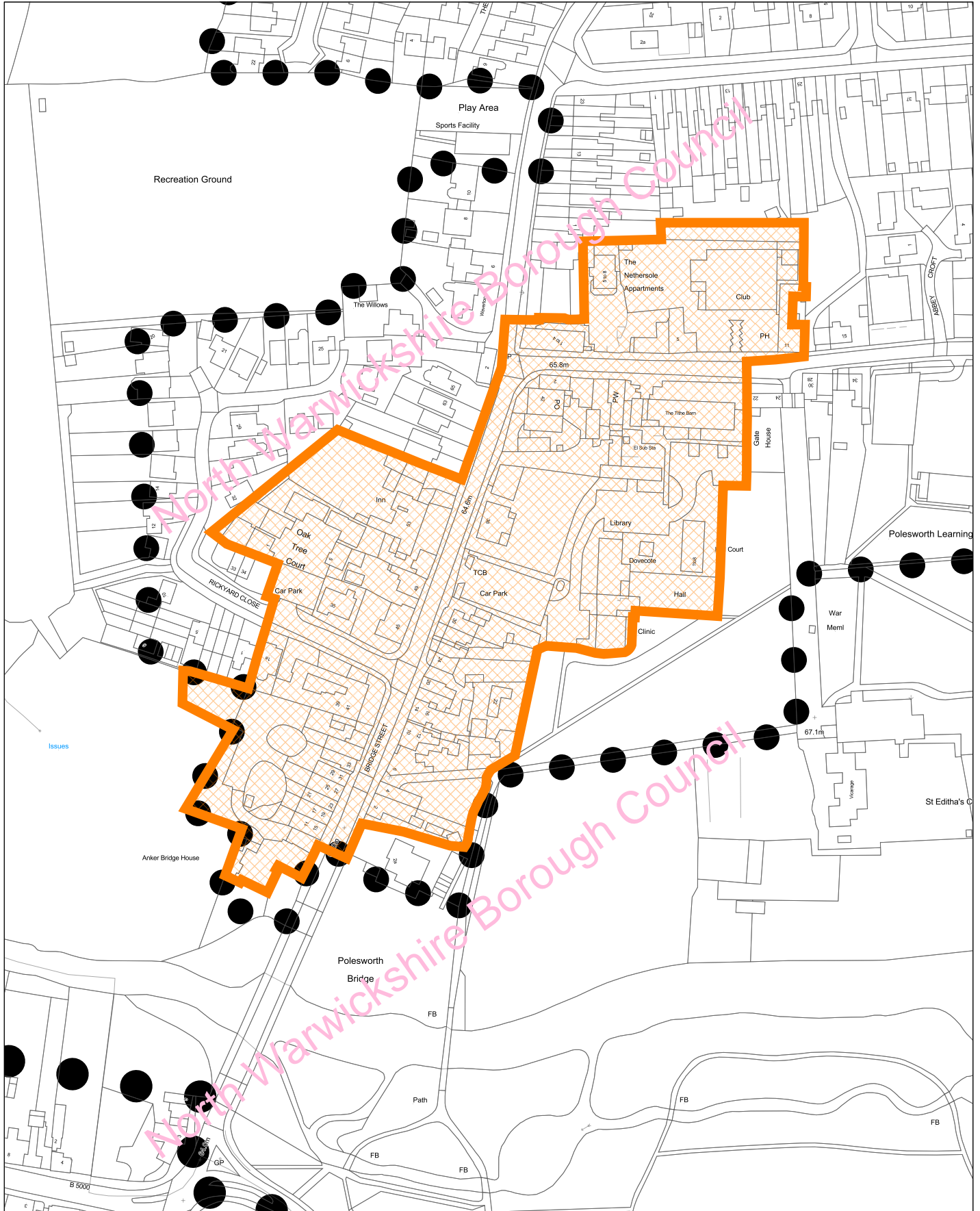

Date: 03:09:21  
Scale: 1:2000

North Warwickshire Local Plan  
Adopted September 2021  
Polesworth Town Centre Boundary

© Crown copyright and database rights 2021  
Ordnance Survey 100017910



North Warwickshire  
Borough Council



Town Centre Boundary



# Policy LP21 - Coleshill Town Centre Boundary

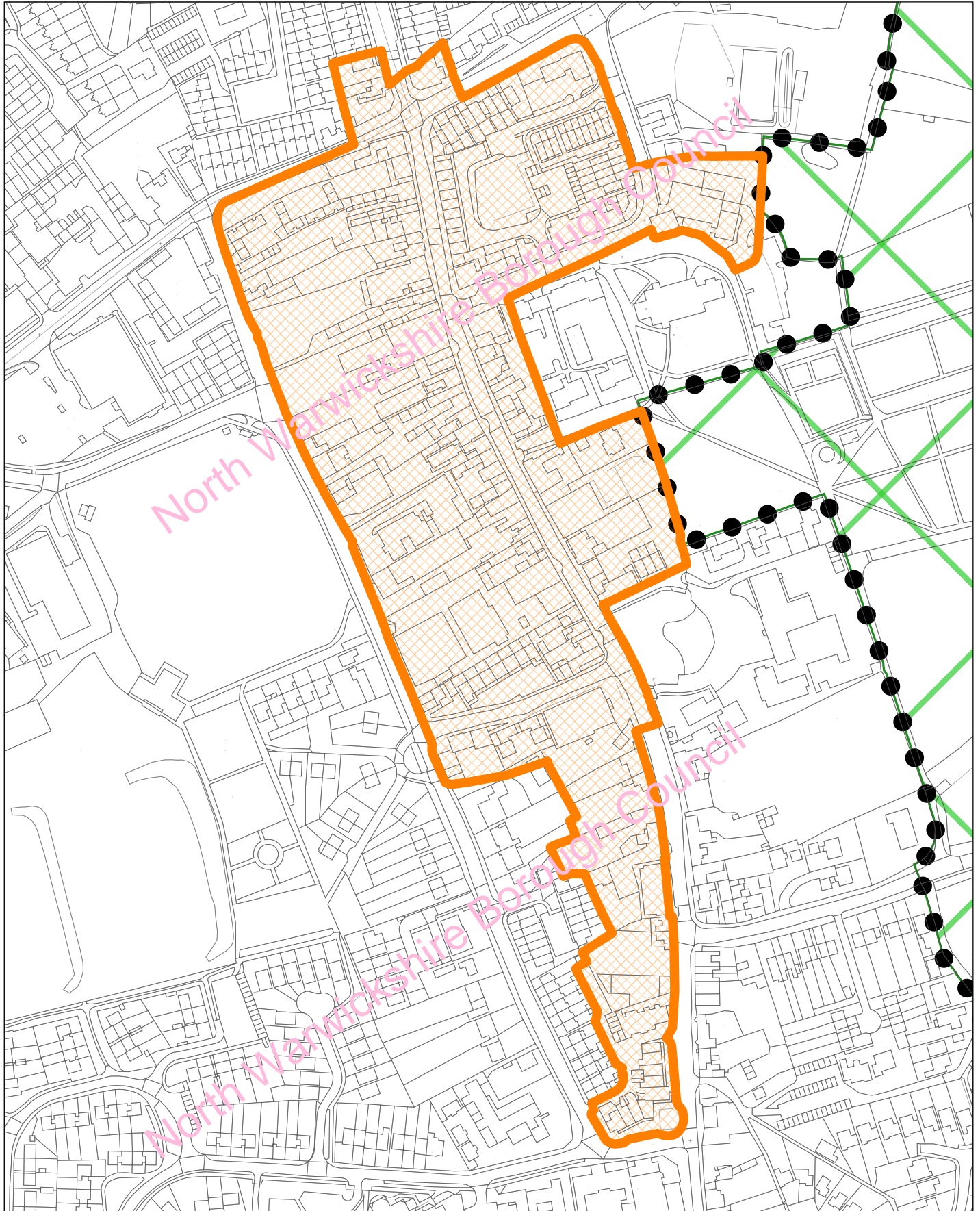

Date: 03:09:21  
Scale: 1:2750

North Warwickshire Local Plan  
Adopted September 2021  
Coleshill Town Centre Boundary

© Crown copyright and database rights 2021  
Ordnance Survey 100017910



North Warwickshire  
Borough Council



Town Centre Boundary





# Policy LP21 - Neighbourhood Centres

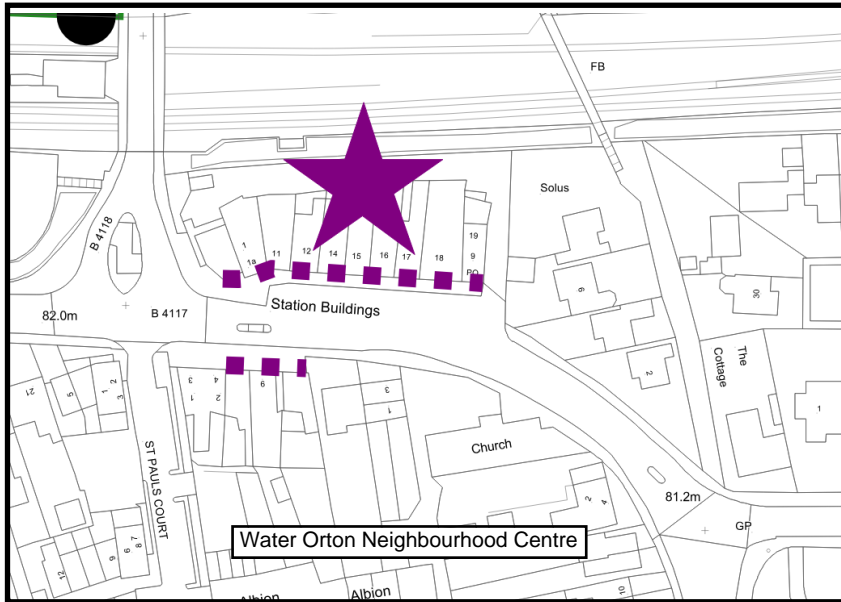

Water Orton Neighbourhood Centre

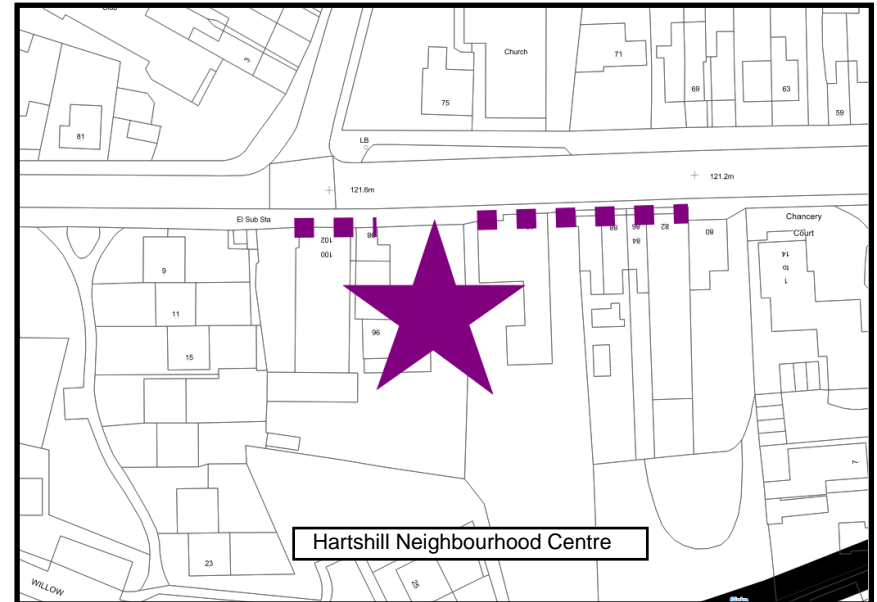

Hartshill Neighbourhood Centre

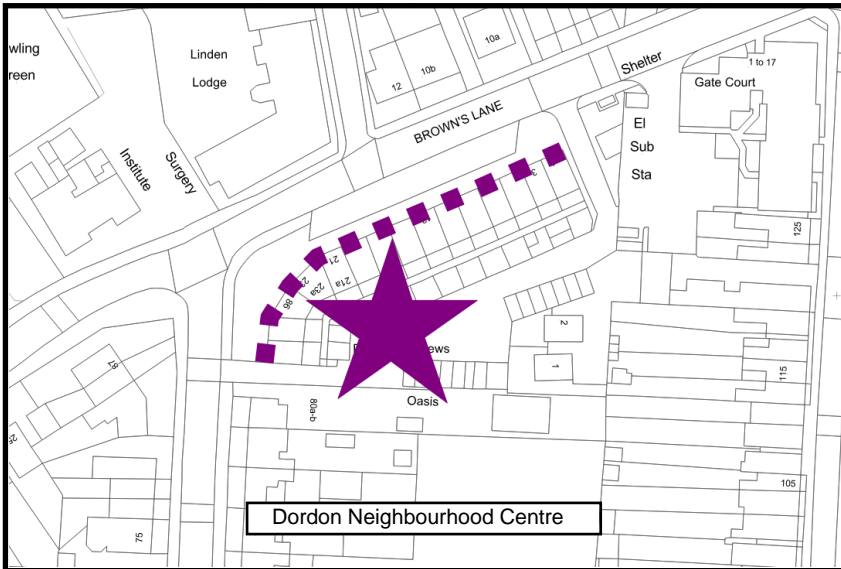

Dordon Neighbourhood Centre

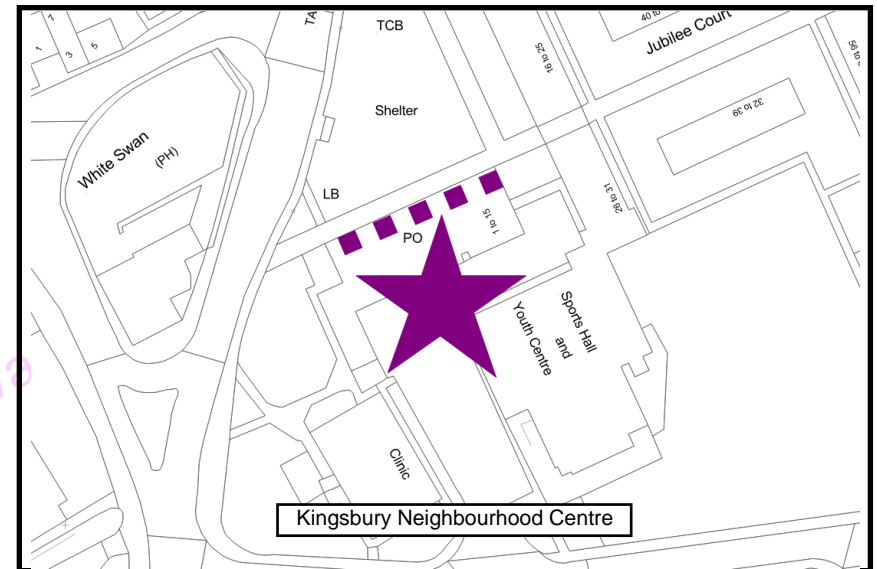

Kingsbury Neighbourhood Centre

Date:03:09:21 North Warwickshire Local Plan  
 Adopted September 2021  
 Neighbourhood Centres

(C) Crown copyright and database rights 2021 Ordnance Survey 100017910



North Warwickshire  
 Borough Council



Neighbourhood Centres



Policy LP24 - Safeguarded Station Site Arley

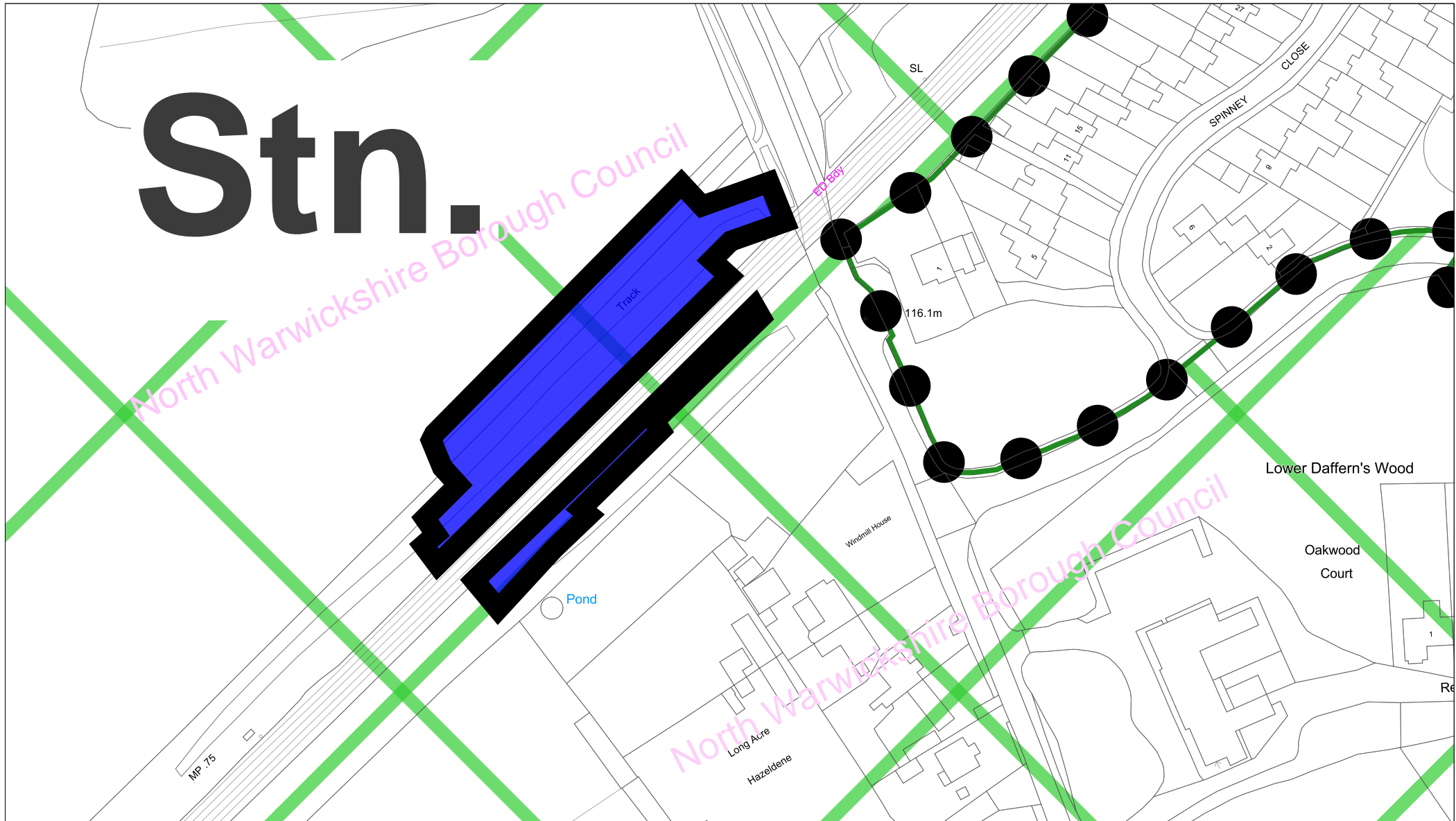

Date:03:09:21  
Scale: 1:1250

North Warwickshire Local Plan  
Adopted September 2021  
Arley Safeguarded Station site

(C) Crown copyright and database rights 2021 Ordnance Survey 100017910



North Warwickshire  
Borough Council



# Policy LP24 - Safeguarded Station Site Kingsbury

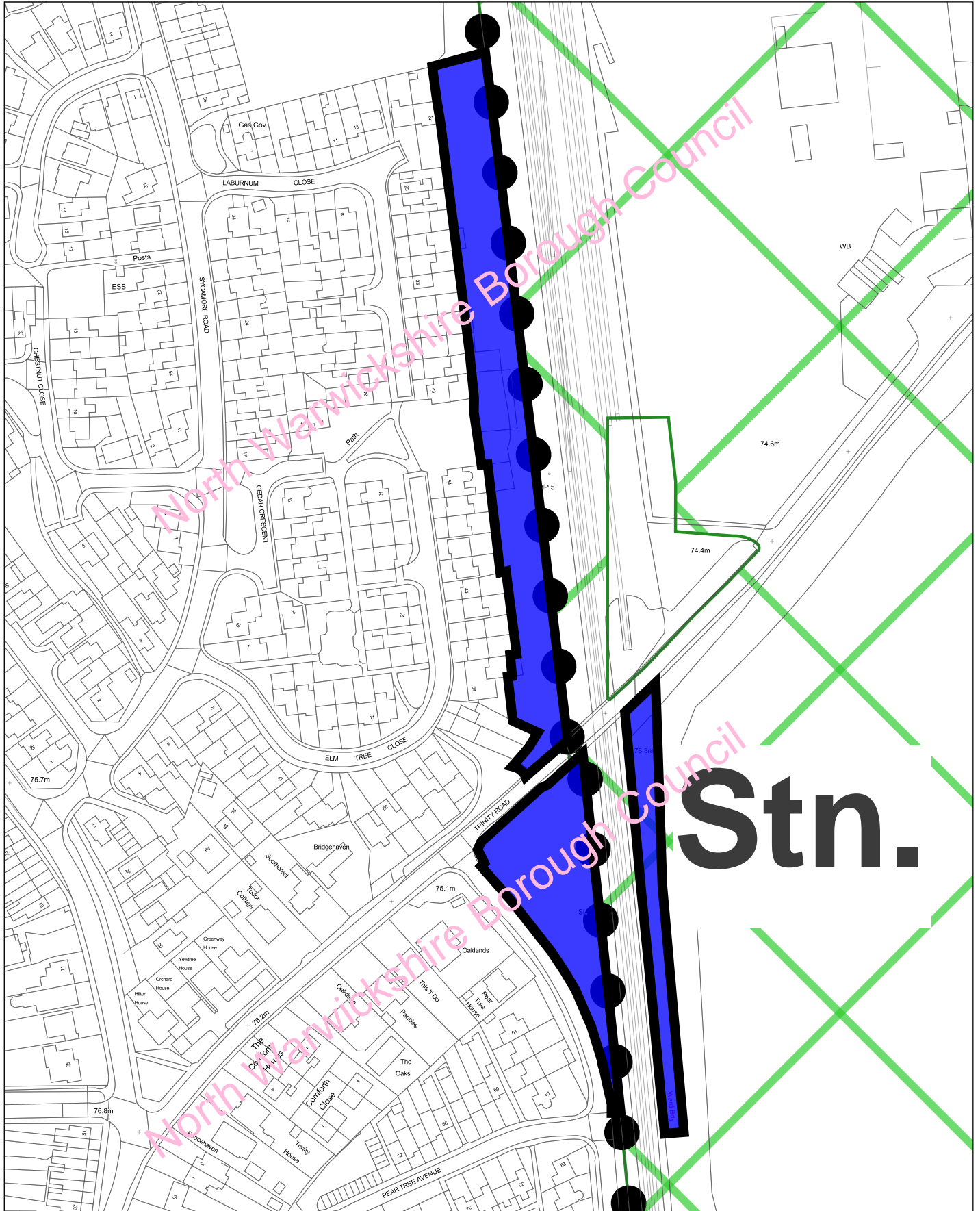

Date: 03:09:21  
 Scale: 1:2000  
 North Warwickshire Local Plan  
 Adopted September 2021  
 Kingsbury Safeguarded Station site

© Crown copyright and database rights 2021  
 Ordnance Survey 100017910



North Warwickshire  
 Borough Council



# Policy LP24 - Atherstone Station - Additional Parking Areas of Search

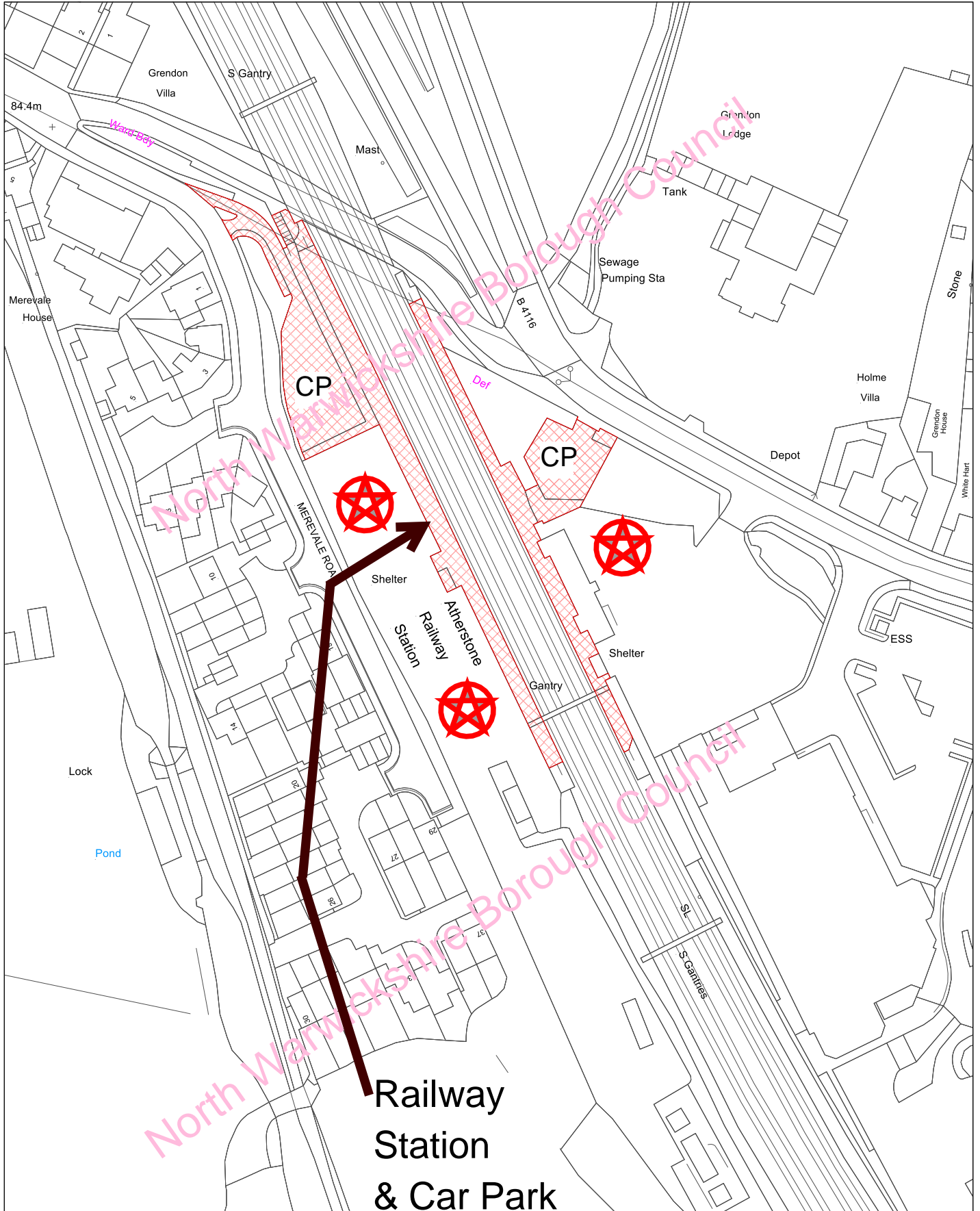

Date:20:01:21  
Scale: 1:1250

North Warwickshire Local Plan  
Adopted September 2021  
Atherstone - Areas of search for additional station parking

© Crown copyright and database rights 2021  
Ordnance Survey 100017910



North Warwickshire  
Borough Council



Area of Search for  
additional parking.



# Policy LP24 - Coleshill Station - Additional Parking - Areas of Search

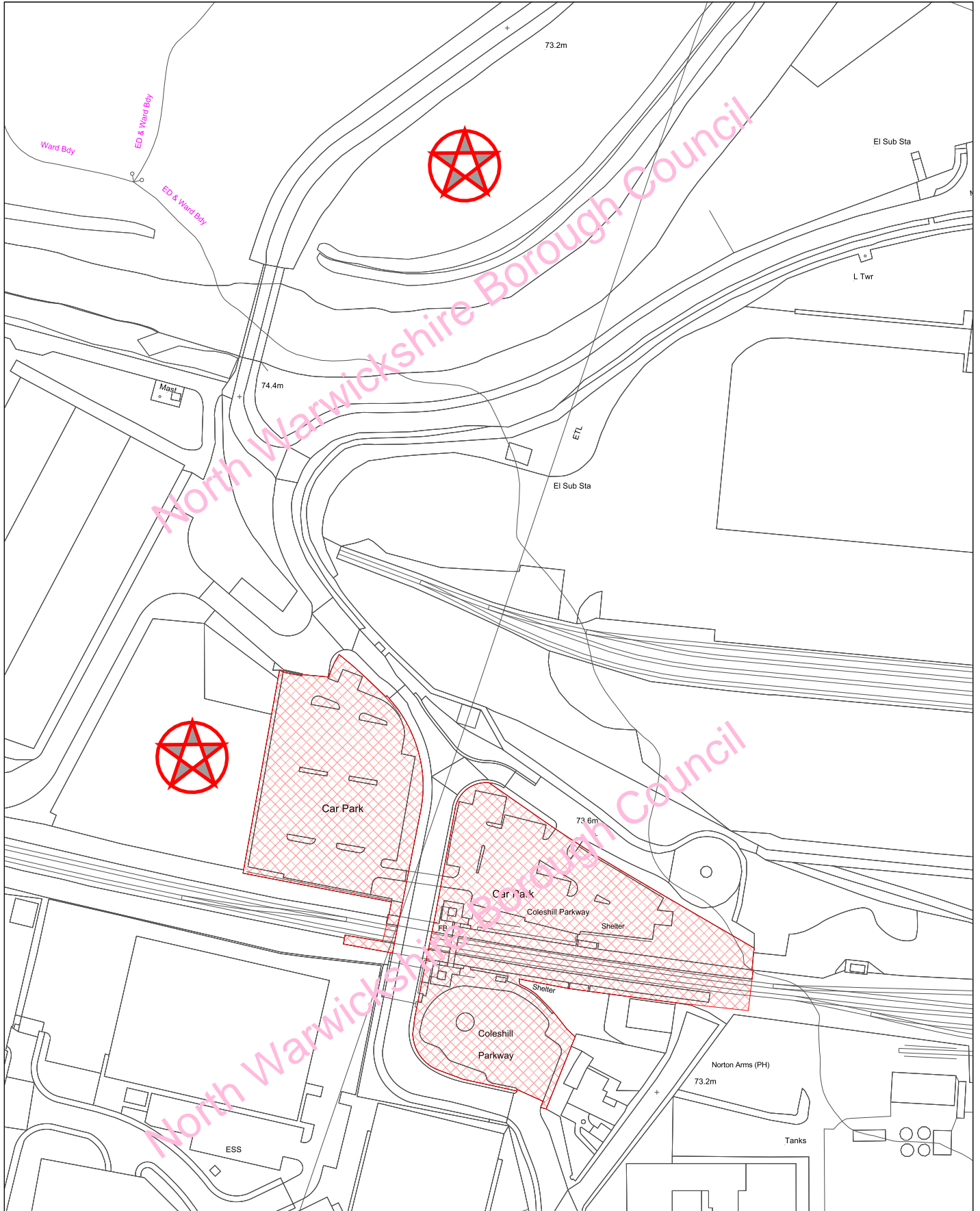

Date: 20:01:21  
Scale: 1:1750

North Warwickshire Local Plan  
Adopted September 2021  
Coleshill Parkway - Areas of search for additional  
station parking

© Crown copyright and database rights 2021  
Ordnance Survey 100017910



North Warwickshire  
Borough Council



Area of Search for  
additional parking.



# Policy LP25 Railway Lines - Safeguarded Route - Former Rail Route from Baxterley to Birch Coppice

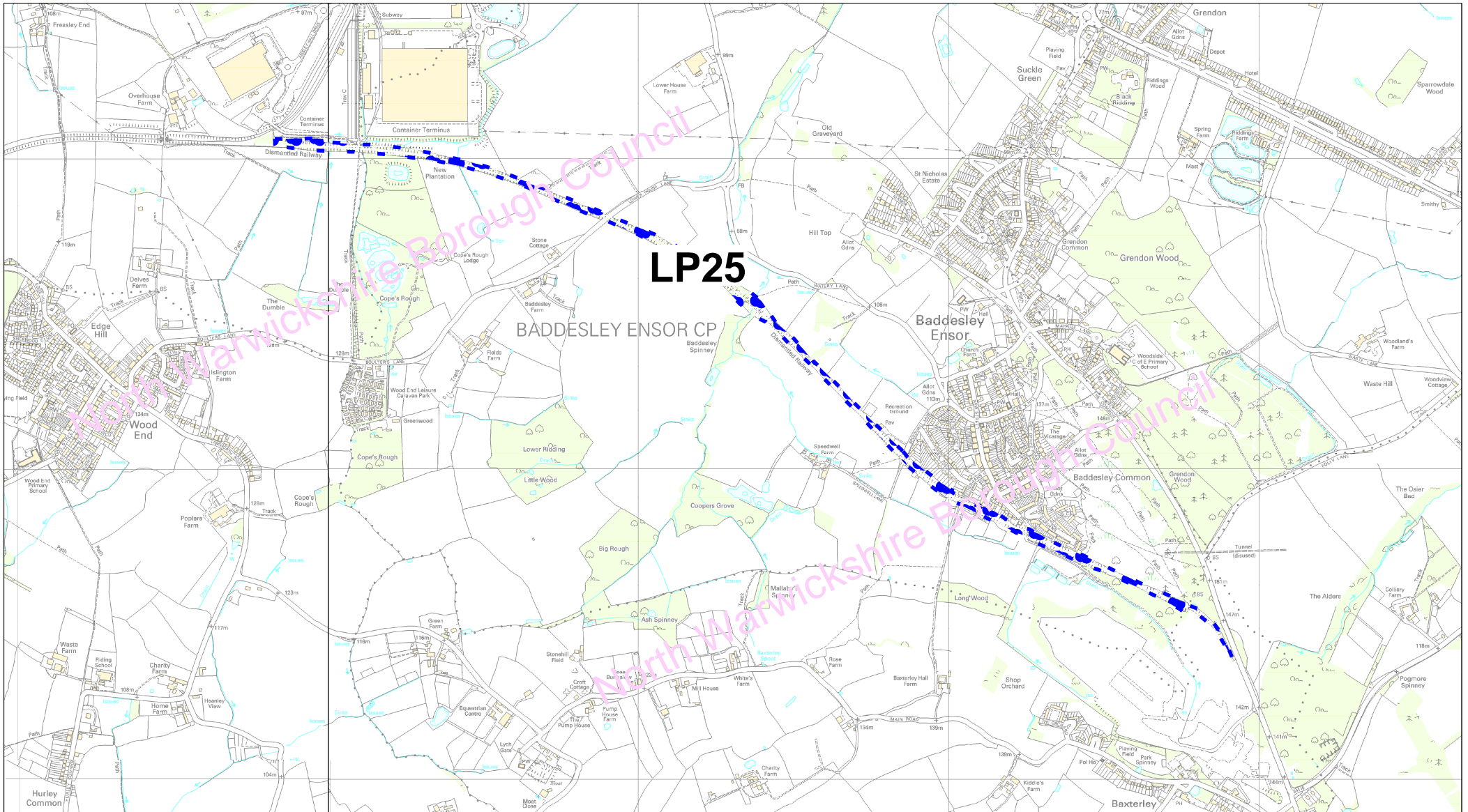

North Warwickshire Local Plan  
 Adopted September 2021  
 Baxterley to Birch Coppice - Safeguarded Route

(C) Crown copyright and database rights 2021 Ordnance Survey 100017910



North Warwickshire  
 Borough Council

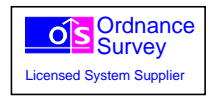

Ordnance  
 Survey  
 Licensed System Supplier

Policy LP25 - Railway Lines - Safeguarded Route - Former Hampton in Arden to Whitacre Rail Route

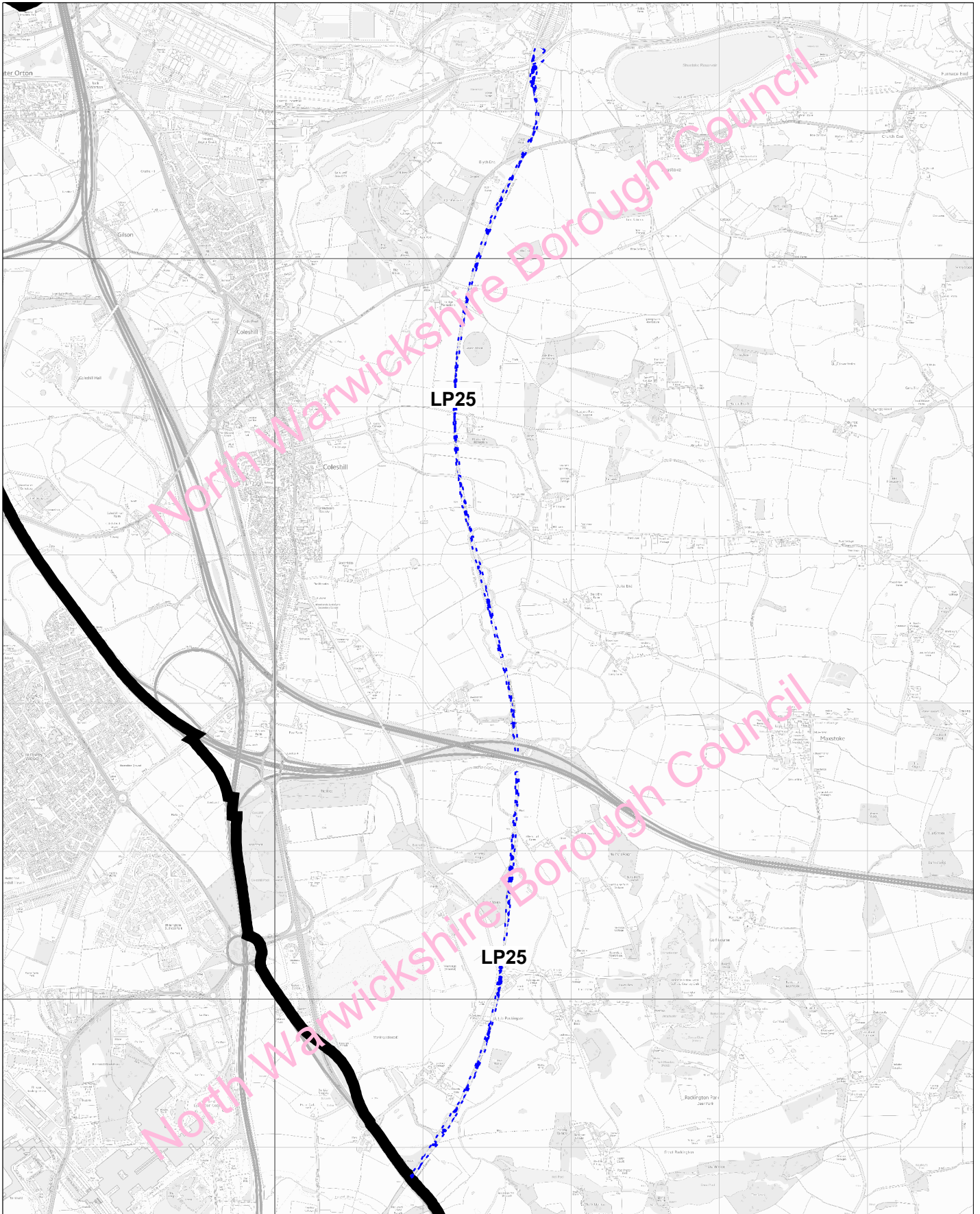

North Warwickshire Local Plan  
Adopted September 2021  
Hampton in Arden to Whitacre - Safeguarded Route

© Crown copyright and database rights 2021  
Ordnance Survey 100017910



Policy LP25 - HS2 Phase 1 and 2b - Safeguarded Route Area

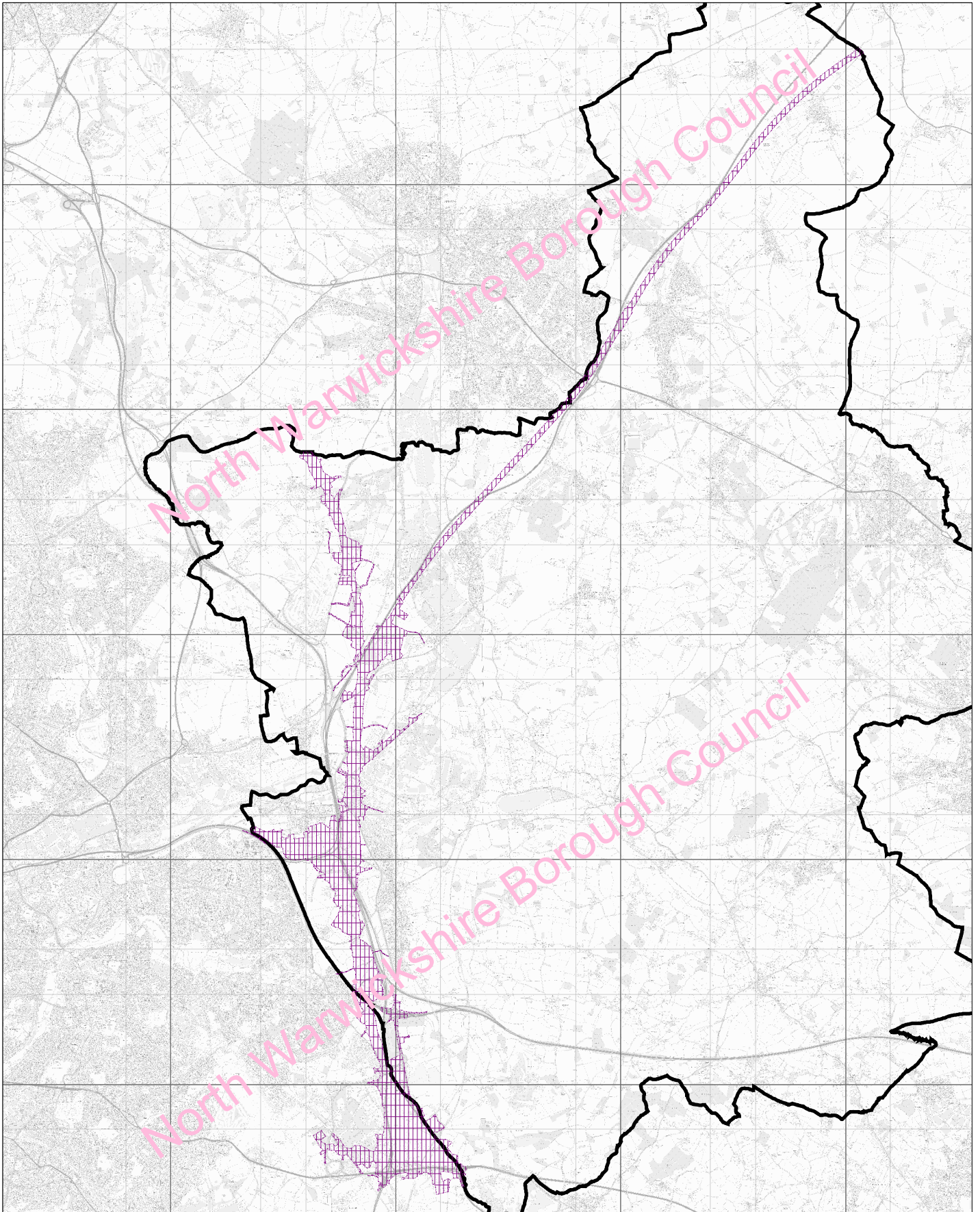

North Warwickshire Local Plan  
Adopted September 2021  
HS2 Safeguarded Route

© Crown copyright and database rights 2021  
Ordnance Survey 100017910

